



25

INSTRUCTION BOOK

TYPE. NS 770C, CGNAME FILTER REGULATOR

DRAWN/ DATE	CHECKED/ DATE	APPROVED/DATE
—	<i>H. Kiyashiro</i> Jan. 9. 77	<i>H. Kiyashiro</i> Jan. 9. 77

NAKAKITA SEISAKUSHO CO., LTD.

1-1. Fukonominami-machi. Daito-city. 〒574-8691 Osaka TEL(072)871-1341
FAX(072)874-7501

(072)871-7871

No.

E222

NS 770C FILTER REGULATOR

1. Method of fixing

- 1) Install the unit paying attention to the letters indicating the direction of air flow. (As for cutting of panel, please refer to the attached dimension drawing. The thickness of panel should be less than 4 T.)

IN Primary pressure (Inlet)

OUT Secondary Pressure (Outlet)

G Secondary side pressure gauge seat

2. Method of adjustment

- 1) Range of decompression is within 1 0 0 0 kPa for primary side and 2 0 - 3 0 0 kPa (or 2 0 - kPa) for secondary side.
- 2) Secondary pressure increases when the handle is turned to the right and decreases when the turned to the left.
- 3) After adjustment, do not forget to tighten the lock-nut.

3. Method of discharge of drain

- 1) Discharge drain by opening the drain cock so that the level of drain should not reach filter.
- 2) Drain cock closes when it is turned to the right and opens when turned to the left.
- 3) When the filter is clogged by dirt, rinse it in water.

4. Trouble shooting and counter-measures

- 1) When various adjustments are infeasible, it is because the unit is fixed in the wrong direction or pressure control spring is broken. Please refix the unit in the orientation correct or replace the spring.
- 2) When secondary pressure does not decrease down to 0, it is because dirt is present in the valve sheet. Please clean it.

5. Cautions

- 1) Maximum tolerable temperature is 60°C.
- 2) When the filter is clogged, please rinse it by either of the following two methods.
 - First wash it by water and then blow compressed air to it from inside to dry it.
 - First immerse it into alcohols or petroleum solvent and then brush it. Then blow compressed air to it from inside to dry it.

SPECIFICATION	
CONNECTION (d)	Rc 1/4
INLET PRESSURE	1 MPa (MAX)
OUTLET PRESSURE	20~300kPa 20~500kPa
ENDURABLE PRESS.	1.5MPa (AIR PRESS.)
FLOW CAPACITY	60 l (Normal)/min ($P_2=140kPa$ 5% PRESS. DROP)
AIR CONSUMPTION	1 l (Normal)/min
MASS	0.7 kg
STANDARD COLOR	SILVER
MAX. WORKING TEMP.	60°C

NO.	PARTS NAME	MATERIAL	QUANTITY	REMARKS
1	BONNET	A.D.C	1	
2	BODY	A.D.C	1	
3	FILTER CASE	A.D.C	1	
10	HANDLE		1	
12	DIAPHRAGM ASSEMBLY	N.B.R C3604B A.D.C	1	
13	PACKING	N.B.R	1	
14	PACKING	N.B.R	1	
15	SPRING	SWPB	1	
16	SPRING	SUS304	1	
19	PILOT VALVE	SUS304	1	
21	DRAIN COCK	C3604B	1	
25	METALIC FILTER	BRONZE	1	
33	PACKING	N.B.R	1	

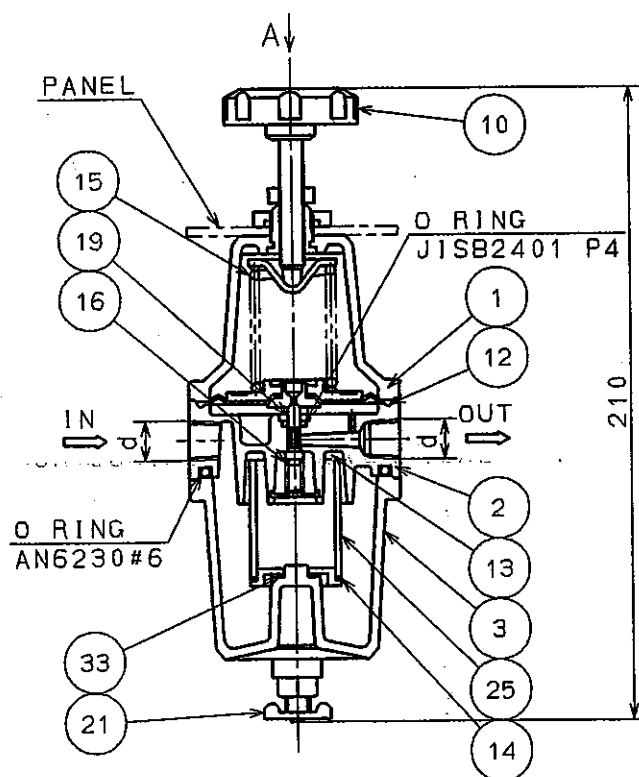
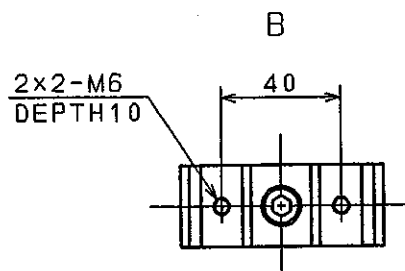
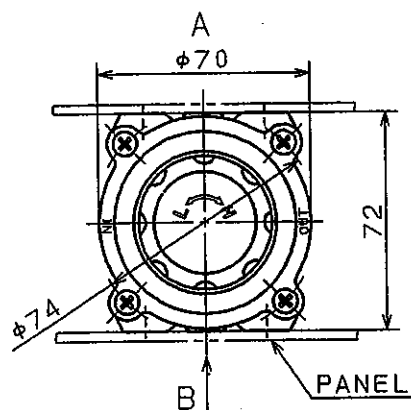

PANEL MOUNTING

HORIZONTAL

VERTICAL

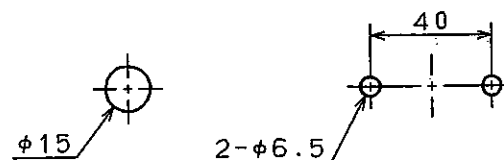

Rev.	REVISIONS			BY/DATE	CHKD/DATE	APPD/DATE
	BY/DATE	CHKD/DATE	APPD/DATE	TYPE: NS 770C FILTER REGULATOR		
	T. NAKAO Oct. 15, '99	K. OZAWA Oct. 15, '99	N. KUROKI Oct. 15, '99			
NAKAKITA SEISAKUSHO CO., LTD.				DWG. No.	AKKK113XZXE	
					Rev.	0

SPECIFICATION	
CONNECTION (d)	Rc 1/4
INLET PRESSURE	1 MPa (MAX)
OUTLET PRESSURE	20~300 kPa 20~500 kPa
ENDURABLE PRESS.	1.5 MPa (AIR PRESS.)
FLOW CAPACITY	60 l (Normal) / min ($P_2=140 \text{ kPa}$ 5% PRESS. DROP)
AIR CONSUMPTION	1 l (Normal) / min
MASS	0.8 kg
STANDARD COLOR	SILVER
MAX. WORKING TEMP.	60°C

NO.	PARTS NAME	MATERIAL	QUANTITY	REMARKS
1	BONNET	A.D.C	1	
2	BODY	A.D.C	1	
3	FILTER CASE	A.D.C	1	
10	HANDLE		1	
12	DIAPHRAGM ASSEMBLY	N.B.R C3604B A.D.C	1	
13	PACKING	N.B.R	1	
14	PACKING	N.B.R	1	
15	SPRING	SWPB	1	
16	SPRING	SUS304	1	
19	PILOT VALVE	SUS304	1	
21	DRAIN COCK	C3604B	1	
25	METALIC FILTER	BRONZE	1	
26	PRESSURE GAUGE		1	
33	PACKING	N.B.R	1	

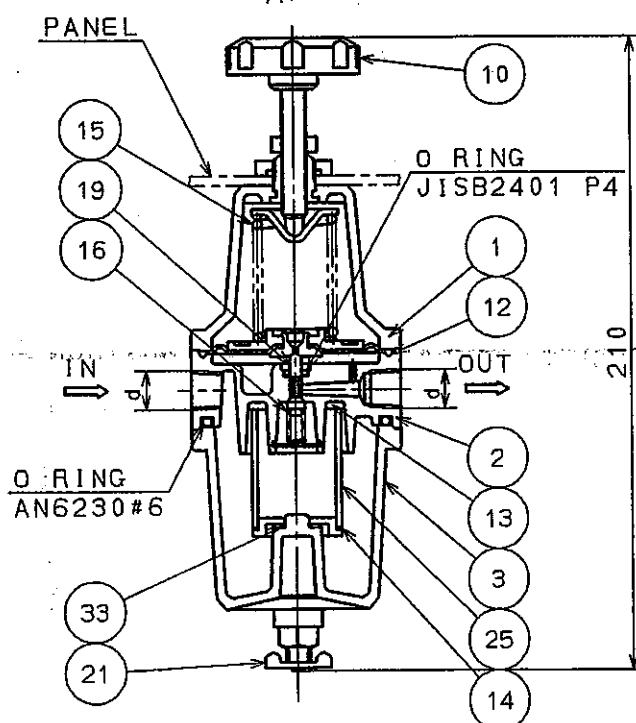
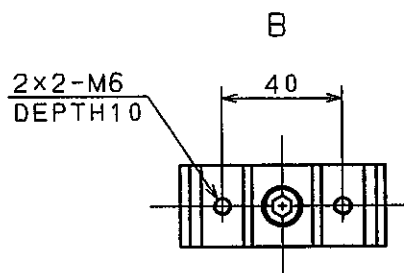
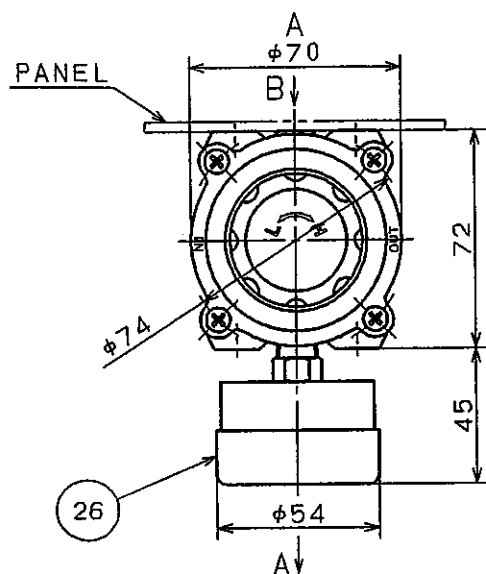

PANEL MOUNTING

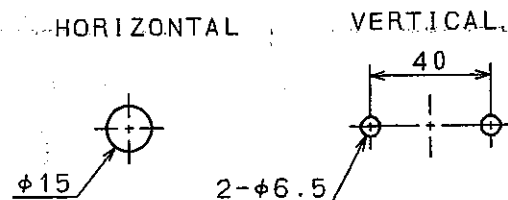

Rev.	REVISIONS			BY/DATE	CHKD/DATE	APPD/DATE
	BY/DATE	CHKD/DATE	APPD/DATE	TYPE.NS	NS 770CG	
	T.NAKAD Oct.15, '99	K.OZAWA Oct.15, '99	N.KUROKI Oct.15, '99		FILTER REGULATOR	
NAKAKITA SEISAKUSHO CO.,LTD.				TYPE.NS	AKKK114XZXE	
						DWG. No. 0